



MANUAL

B760M-T

GAMING MOTHERBOARD

IMPORTANTE

É DE EXTREMA IMPORTÂNCIA LER, COMPREENDER E SEGUIR TODAS AS INSTRUÇÕES CONTIDAS NESTE MANUAL. FALHAS OCACIONADAS PELO MANUSEIO INCORRETO PODEM RESULTAR EM DANOS AO EQUIPAMENTO E POSSÍVEL ANULAÇÃO DA GARANTIA.

3

Interface e Instruções

Conectores de Alimentação ATX

Existem dois tipos de conectores de alimentação ATX: EARXPWR de 24 pinos e EATX12V de 4/8 pinos.

Os conectores de alimentação são projetados para se encaixar apenas em uma orientação. Encontre a orientação correta e pressione firmemente até que os conectores se encaixem completamente.

Observação: Ambos os conectores de alimentação devem ser conectados ao mesmo tempo, caso contrário, o computador não poderá ser inicializado.

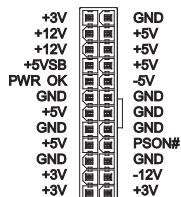

Conexão de ventoinhas

O conector na placa mãe está disponível tanto para ventoinha do processador quanto para da CPU. O fio vermelho deve ser conectado ao pino de alimentação +12V, e o fio preto deve ser conectado ao fio de terra.

Pino	Definição
Pino 1	GND
Pino 2	FAN PWR
Pino 3	FAN IN
Pino 4	FAN PWM

Ventoinha padrão Ventoinha de CPU



Conexão USB

Existem USB padrão e USB de 9 pinos na placa mãe. O USB padrão pode ser conectado diretamente a dispositivos USB, enquanto o USB de 9 pinos requer um cabo de extensão USB.

Além disso, parte da placa mãe suporta a especificação USB 3.0, que pode fornecer uma taxa de transmissão muito superior a 2.0. A diferença significativa em relação à interface 2.0 é o uso de um material plástico azul, e os conectores estendidos também aumentaram para 20 pinos.

USB padrão

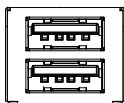

Definição de Pino USB 2.0

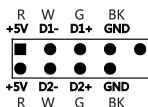

Definição de Pino USB 2.0

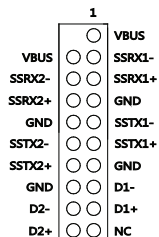

Áudio frontal

A placa mãe fornece uma interface de saída de áudio no painel frontal. O usuário pode usar o painel de saída de áudio frontal para substituir o painel traseiro da placa mãe. Por favor, conecte de acordo com as definições dos pinos.

Definição dos pinos de áudio frontais

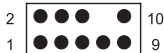

Pino	Definição	Pino	Definição
Pino 1	PORT1 L	Pino 6	SENSE1_RETUR
Pino 2	GND	Pino 7	SENSE_SEND
Pino 3	PORT1 R	Pino 8	Sem pino
Pino 4	PRESENCE#	Pino 9	PORT2L
Pino 5	PORT 2 R	Pino 10	SENSE2_RETUR

COM

A placa mãe fornece uma interface de expansão de pinos de saída serial. Os usuários podem adquirir um cabo de extensão serial D8-9 para adicionar uma interface serial RS-232C padrão. Para conectar o dispositivo serial, existem dois tipos de pinos, conforme abaixo:

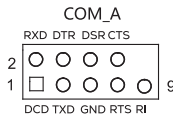
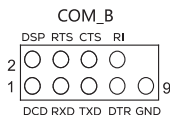

Definição de pino DB9

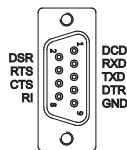

Botão POWER

Este conector de 2 pinos controla a chave principal da fonte de alimentação ATX, e conectar os dois pinos Power ON ligará o dispositivo.

HDD LED

O LED mostra o estado de funcionamento do disco rígido. Conecte o cabo HDD de acordo com os logotipos positivo e negativo, como LED+ HDD e LED- HDD.

POWER LED

O LED de alimentação é um conector de 3 pinos. Deve ser conectado de acordo com as polaridades LED+ Power e LED- Power positivas e negativas. O LED de alimentação serve para exibir o estado atual do computador, acendendo, piscando ou desligando de acordo com a situação.

Botão RESET

O botão de reset pode reiniciar o computador sem desligar a fonte de alimentação, conectando-o com o cabo de reset de 2 pinos no gabinete do computador.

O cabo do alto-falante com 4 pinos tem uma direção. Conecte o cabo de 4 pinos no gabinete do computador de acordo com os pinos correspondentes. O cabo vermelho deve ser conectado ao polo positivo.

Observação: Existem dois tipos de cabos no painel do gabinete, como abaixo:

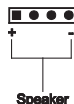
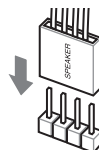
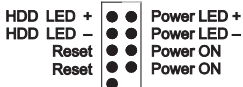
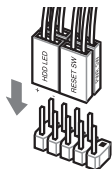

Instalando a memória

1

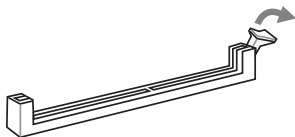

Abra os cliques de segurança nas extremidades (variam de acordo com os modelos de placa mãe).

2 Coloque o módulo de memória no soquete e insira a memória verticalmente no soquete.

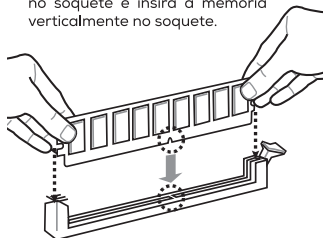

Instalando a unidade M.2

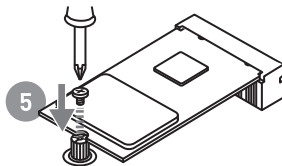
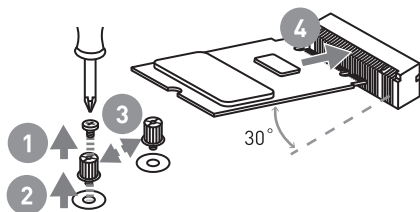

- Remova o parafuso da base do parafuso.
- Remova a base do parafuso.
- Aperte a base do parafuso no furo a uma distância do slot M.2 correspondente ao comprimento do seu drive M.2.
- Insira o drive M.2 no slot M.2 a um ângulo de 30 graus.
- Coloque o parafuso na ranhura na borda traseira do seu módulo M.2 e aperte-o na base do parafuso.

Instalando a unidade SATA

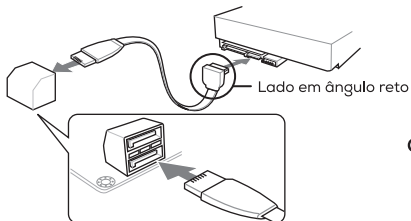

Ou

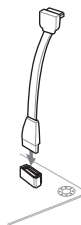

Conecte o lado vertical ao dispositivo SATA ou à porta SATA na placa mãe.

Instalando a CPU INTEL

Processador LGA1700

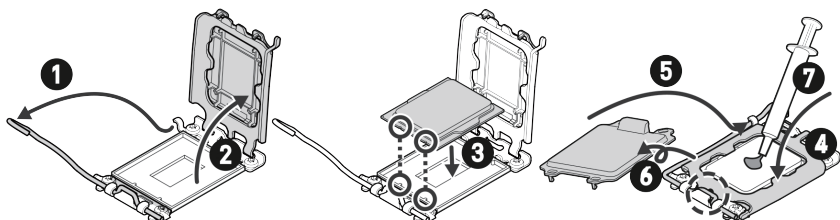

Processador LGA1200/LGA115X

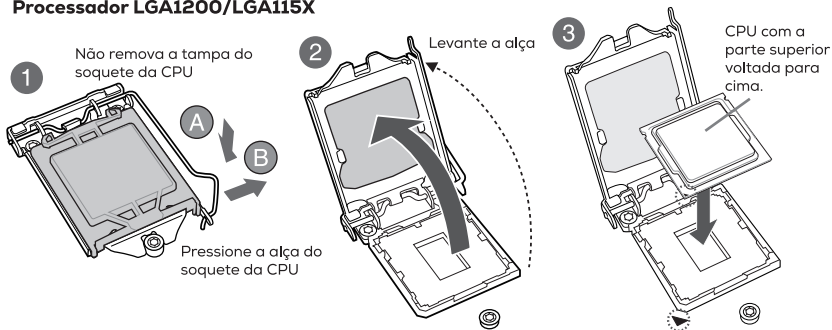

Instalação do cooler da CPU

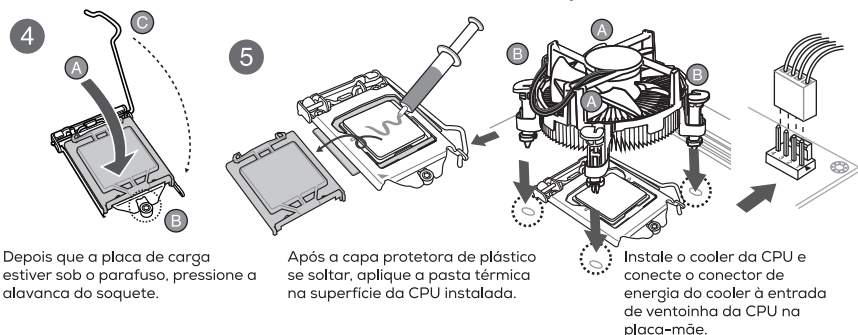

Tamanho da Placa-Mãe

- Micro ATX

Chipset

- Suporte para Processadores Intel Core 12/13 th I9/I7/I5/I3/Pentium LGA1700

CPU

- B760

Memória

- DDR4 Dual Channel; Suporte para frequências 2133/2400/2666/3000/3200/3600 MHZ, suporte ao XMP
- Máx 64GB (32GB*2)
- 2 slots DDR4 de 288 pinos

Portas Traseiras (Rear I/O)

- PS/2: 1 porta KB + 1 porta MS
- Porta de Vídeo: 1 porta HDMI + 1 porta VGA + 1 porta DP
- Portas USB: 4 portas USB 2.0; 2 portas USB 3.1
- Ethernet: Gigabit
- Áudio: 1 entrada de microfone (Mic-in), 1 saída de linha (Line-out), 1 entrada de linha (Line-in)

Conectores Internos

- Conector CFAN: 1 conector de ventoinha de 4 pinos
- Conectores SFAN: 2 conectores (1 de 4 pinos + 1 de 3 pinos)
- Porta ATPWR: 1 tomada de energia padrão de 8 pinos; 1 tomada de energia padrão de 24 pinos
- USB2.0: 2 conectores (Um FUSB pode gerar duas portas USB2.0)
- USB3.0: 2 conectores (Um FUSB pode gerar duas portas USB3.0)
- Porta COM: 1 conector de 2x5 pinos
- Porta WIFI: 1 suporta os protocolos CNVI e PCIe
- TPM: 1 conector de 2x6 pinos (Suporta o módulo TPM MSI)
- Portas SATA: 4 portas SATA3.0
- M.2: 1 (largura de banda PCIe GEN4 X4)
- F_AUDIO: 1 conector de 2x5 pinos
- PCIe: 1 slot PCIe X16 4.0; 1 slot PCIe X1 3.0
- F_PANEL: 1 conector de 2x5 pinos

**AGRADECEMOS POR ESCOLHER O PICHAU GROUP
COMO PARTE DA SUA JORNADA.**

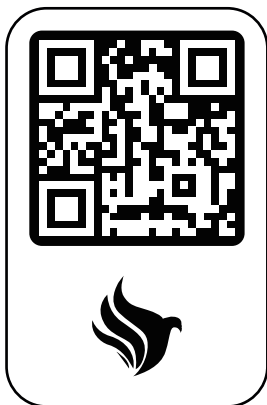

**EXPLORE NOSSOS SITES E ENCONTRE O
PRODUTO IDEAL PARA ELEVAR SUA EXPERIÊNCIA.**



USER MANUAL

B760M-T

GAMING MOTHERBOARD

IMPORTANT

IT IS EXTREMELY IMPORTANT TO READ, UNDERSTAND, AND FOLLOW ALL INSTRUCTIONS IN THIS MANUAL. INCORRECT HANDLING MAY DAMAGE THE EQUIPMENT AND VOID THE WARRANTY.

3

INTERFACE AND INSTRUCTIONS

ATX Power Connectors

There are two types of ATX power connectors: 24-pin EARXPWR and 4/8-pin EATX12V. The power connectors are designed to fit in only one orientation. Find the correct orientation and press firmly until the connectors are completely engaged.

Note: Both power connectors must be connected at the same time, otherwise the computer cannot be initialized.

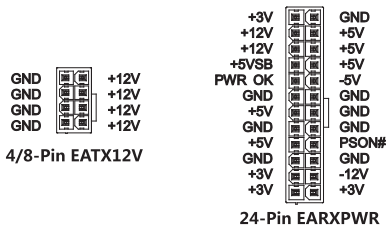

Fan Connection

The connector on the motherboard is available both for the processor fan and for the CPU. The red wire must be connected to the +12V power pin, and the black wire must be connected to the ground wire.

Pin	Definition
Pin 1	GND
Pin 2	FAN PWR
Pin 3	FAN IN
Pin 4	FAN PWM

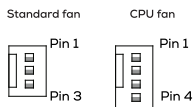

USB Connection

There are standard USB and 9-pin USB on the motherboard. The standard USB can be connected directly to USB devices, while the 9-pin USB requires a USB extension cable.

In addition, part of the motherboard supports the USB 3.0 specification, which can provide a much higher transmission rate than 2.0. The significant difference compared to the 2.0 interface is the use of a blue plastic material, and the extended connectors also increased to 20 pins.

Standard USB

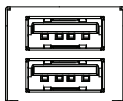

USB 2.0 Pin Definition

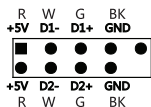

USB 2.0 Pin Definition

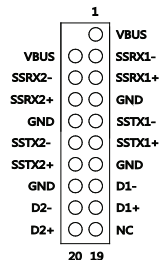

Front audio

The motherboard provides a front panel audio output interface. The user can use the front audio output panel to replace the motherboard's rear panel. Please connect according to the pin definitions.

Front audio pin definition

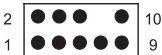

Pin	Definition	Pin	Definition
Pin 1	PORT1 L	Pin 6	SENSE1_RETUR
Pin 2	GND	Pin 7	SENSE_SEND
Pin 3	PORT1 R	Pin 8	No pin
Pin 4	PRESENCE#	Pin 9	PORT2L
Pin 5	PORT 2 R	Pin 10	SENSE2_RETUR

COM

The motherboard provides a serial output pin expansion interface. Users can purchase a DB-9 serial extension cable to add a standard RS-232C serial interface. To connect the serial device, there are two types of pins, as below:

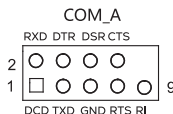
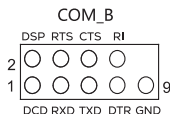

DB9 pin definition

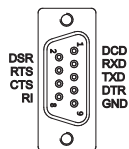

POWER Button

This 2-pin connector controls the main switch of the ATX power supply, and connecting the two Power ON pins will turn on the device.

HDD LED

The LED shows the operating status of the hard drive. Connect the HDD cable according to the positive and negative logos, such as LED+ HDD and LED- HDD.

POWER LED

The power LED is a 3-pin connector. It must be connected according to the positive and negative LED+ Power and LED- Power polarities. The power LED serves to display the current status of the computer, lighting up, flashing or turning off according to the situation.

RESET Button

The reset button can restart the computer without turning off the power supply, connecting it with the 2-pin reset cable in the computer case.

The 4-pin speaker cable has a direction. Connect the 4-pin cable in the computer case according to the corresponding pins. The red wire must be connected to the positive pole.

Note: There are two types of cables on the case panel, as below:

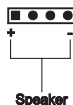
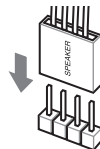
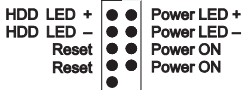
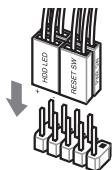

Installing the memory

1

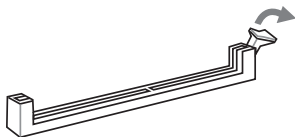

Open the safety clips at the ends (vary according to motherboard models)

2 Place the memory module into the socket and insert the memory vertically into the socket.

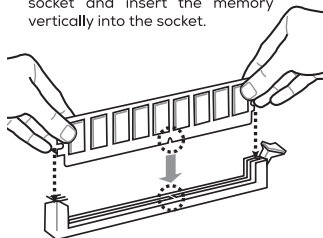

Installing the M.2 unit

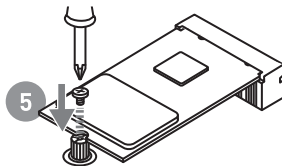
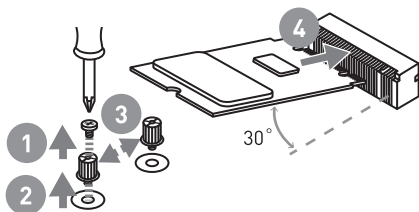

- Remove the screw from the screw base.
- Remove the screw base.
- Tighten the screw base into the hole at a distance from the M.2 slot corresponding to the length of your M.2 drive.
- Insert the M.2 drive into the M.2 slot at a 30-degree angle.
- Place the screw in the slot on the rear edge of your M.2 module and tighten it into the screw base.

Installing the SATA unit

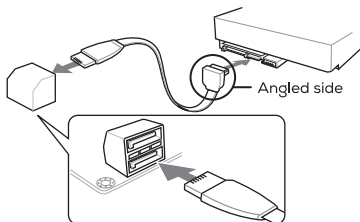

Or

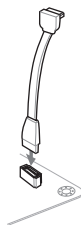

Connect the vertical side to the SATA device or to the SATA port on the motherboard.

Installing the INTEL CPU

LGA1700 Processor

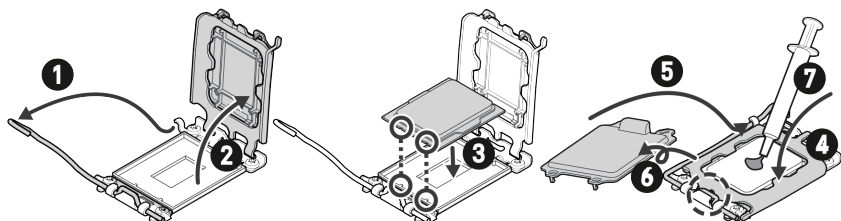

LGA1200/LGA115X Processor

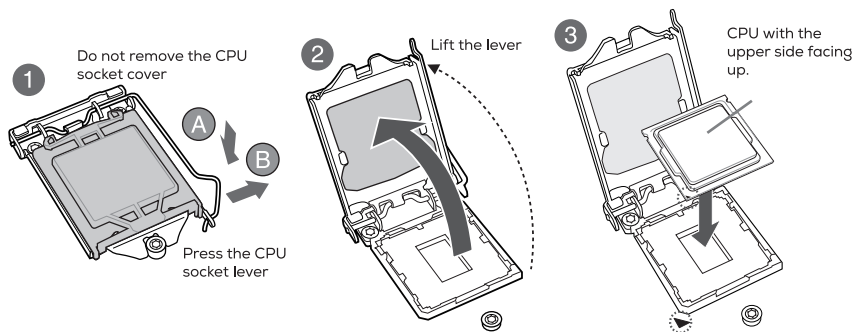

Installing the CPU cooler

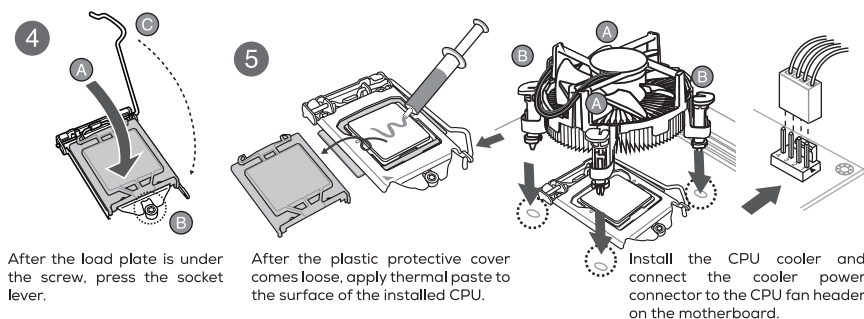

6



Keep the cover properly and always replace it when the CPU is not installed.

Motherboard Size

- Micro ATX

Chipset

- Support for Intel Core 12/13 th i9/i7/i5/i3/Pentium LGA1700 Processors

CPU

- B760

Memory

- DDR4 Dual Channel: Support for frequencies 2133/2400/2666/3000/3200/3600 MHZ, XMP support
- Max 64GB (32GB*2)
- 2 DDR4 slots of 288 pins

Rear Ports (Rear I/O)

- PS/2: 1 KB port + 1 MS port
- Video Port: 1 HDMI port + 1 VGA port + 1 DP port
- USB Ports: 4 USB 2.0 ports; 2 USB 3.1 ports
- Ethernet: Gigabit
- Audio: 1 microphone input (Mic-in), 1 line output (Line-out), 1 line input (Line-in)

Internal Connectors

- CFAN Connector: 1 4-pin fan connector
- SFAN Connectors: 2 connectors (1 of 4 pins + 1 of 3 pins)
- ATXPWR Port: 1 standard 8-pin power socket; 1 standard 24-pin power socket
- USB2.0: 1 connectors (One FUSB can generate two USB2.0 ports)
- USB3.0: 1 connectors (One FUSB can generate two USB3.0 ports)
- COM Port: 1 connector of 2x5 pins
- WIFI Port: 1 supports CNVi and PCIe protocols
- TPM: 1 connector of 2x6 pins (Supports MSI TPM module)
- SATA Ports: 4 SATA3.0 ports
- M.2: 1 (PCIe GEN4 X4 bandwidth)
- F_AUDIO: 1 connector of 2x5 pins
- PCIe: 1 PCIe X16 4.0 slot; 1 PCIe X1 3.0 slot
- F_PANEL: 1 connector of 2x5 pins

**THANK YOU FOR CHOOSING PICHAU GROUP
AS PART OF YOUR JOURNEY.**



PICHAU

**EXPLORE OUR WEBSITES AND FIND THE
IDEAL PRODUCT TO ELEVATE YOUR EXPERIENCE.**



MANUAL DEL USUARIO
B760M-T

GAMING MOTHERBOARD

IMPORTANTE

ES DE EXTREMA IMPORTANCIA LEER, COMPRENDER Y SEGUIR TODAS LAS INSTRUCCIONES CONTENIDAS EN ESTE MANUAL. LAS FALLAS OCASIONADAS POR EL MANEJO INCORRECTO PUEDEN RESULTAR EN DAÑOS AL EQUIPO Y LA POSIBLE ANULACIÓN DE LA GARANTÍA.

3

INTERFAZ E INSTRUCCIONES

Conectores de Alimentación ATX

Existen dos tipos de conectores de alimentación ATX: EARXPWR de 24 pines y EATX12V de 4/8 pines. Los conectores de alimentación están diseñados para encajar en una sola orientación. Encuentre la orientación correcta y presione firmemente hasta que los conectores encajen por completo.

Nota: Ambos conectores de alimentación deben estar conectados al mismo tiempo, de lo contrario, la computadora no podrá iniciarse.

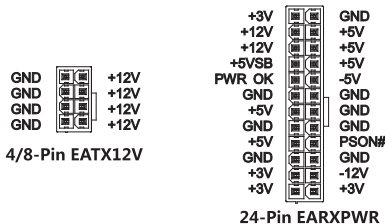

Conexión de ventiladores

El conector en la placa madre está disponible tanto para el ventilador del procesador como para el de la CPU. El cable rojo debe conectarse al pin de alimentación de +12V, y el cable negro debe conectarse al cable de tierra.

Pin	Definición
Pin 1	GND
Pin 2	FAN PWR
Pin 3	FAN IN
Pin 4	FAN PWM

Ventilador estándar Ventilador de CPU



Conexión USB

Existen USB estándar y USB de 9 pines en la placa madre. El USB estándar se puede conectar directamente a dispositivos USB, mientras que el USB de 9 pines requiere un cable de extensión USB.

Además, parte de la placa madre soporta la especificación USB 3.0, que puede proporcionar una tasa de transmisión muy superior a 2.0. La diferencia significativa en relación con la interfaz 2.0 es el uso de un material plástico azul, y los conectores extendidos también aumentaron a 20 pines.

USB estándar

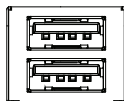

Definición de Pin USB 2.0

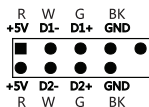

Definición de Pin USB 2.0

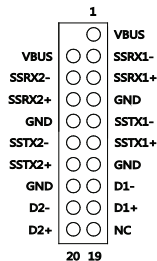

Audio frontal

La placa madre proporciona una interfaz de salida de audio en el panel frontal. El usuario puede usar el panel de salida de audio frontal para reemplazar el panel trasero de la placa madre. Por favor, conecte de acuerdo con las definiciones de los pines.

Definición de los pines de audio frontales

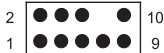

Pin	Definición	Pin	Definición
Pin 1	PORT1 L	Pin 6	SENSE1_RETUR
Pin 2	GND	Pin 7	SENSE_SEND
Pin 3	PORT1 R	Pin 8	Sem pino
Pin 4	PRESENCE#	Pin 9	PORT2L
Pin 5	PORT 2 R	Pin 10	SENSE2_RETUR

COM

La placa madre proporciona una interfaz de expansión de pines de salida serial. Los usuarios pueden adquirir un cable de extensión serial DB-9 para agregar una interfaz serial RS-232C estándar. Para conectar el dispositivo serial, existen dos tipos de pines, conforme a continuación:

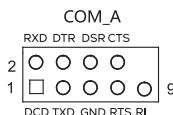
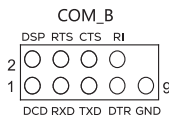

Definición de pin DB9

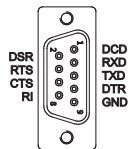

Botón POWER

Este conector de 2 pines controla la llave principal de la fuente de alimentación ATX, y conectar los dos pines Power ON encenderá el dispositivo.

HDD LED

El LED muestra el estado de funcionamiento del disco rígido. Conecte el cable HDD de acuerdo con los logotipos positivo y negativo, como LED+ HDD y LED- HDD.

POWER LED

El LED de alimentación es un conector de 3 pines. Debe ser conectado de acuerdo con las polaridades LED+ Power y LED- Power positivas y negativas. El LED de alimentación sirve para exhibir el estado actual de la computadora, encendiéndose, parpadeando o apagándose de acuerdo con la situación.

Botón RESET

El botón de reset puede reiniciar la computadora sin apagar la fuente de alimentación, conectándolo con el cable de reset de 2 pines en el gabinete de la computadora.

El cable del altavoz con 4 pines tiene una dirección. Conecte el cable de 4 pines en el gabinete de la computadora de acuerdo con los pines correspondientes. El cable rojo debe ser conectado al polo positivo.

Nota: Existen dos tipos de cables en el panel del gabinete, como abajo:

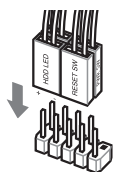

HDD LED +
HDD LED -
Reset
Reset

Power LED +
Power LED -
Power ON
Power ON

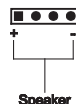
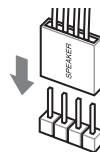

Instalando la memoria

1

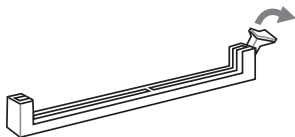

Abra los clips de seguridad en los extremos (varían de acuerdo con los modelos de placa madre)

2 Coloque el módulo de memoria en el zócalo e inserte la memoria verticalmente en el zócalo.

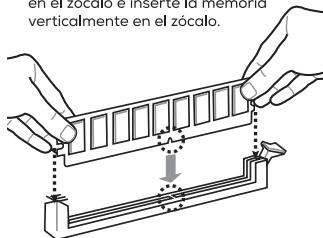

Instalando la unidad M.2

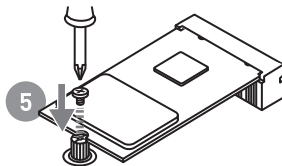
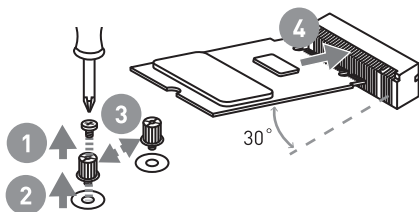

- Retire el tornillo de la base del tornillo.
- Retire la base del tornillo.
- Apriete la base del tornillo en el orificio a una distancia del slot M.2 correspondiente a la longitud de su unidad M.2.
- Inserte la unidad M.2 en el slot M.2 a un ángulo de 30 grados.
- Coloque el tornillo en la ranura del borde trasero de su módulo M.2 y apriételo en la base del tornillo.

Instalando la unidad SATA

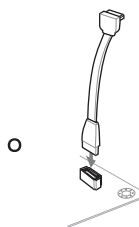
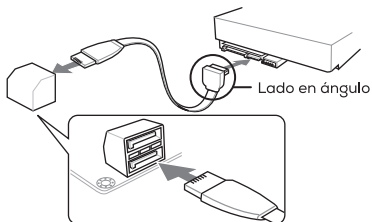

Conecte el lado vertical al dispositivo SATA o al puerto SATA en la placa madre.

Instalando la CPU INTEL

Procesador LGA1700

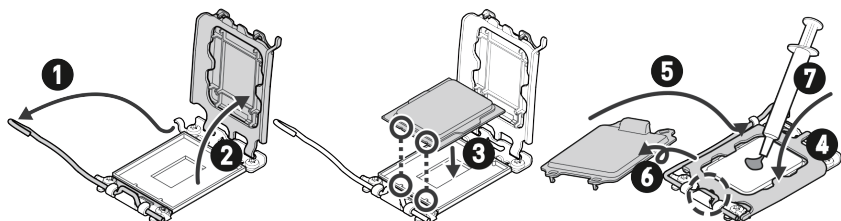

Procesador LGA1200/LGA115X

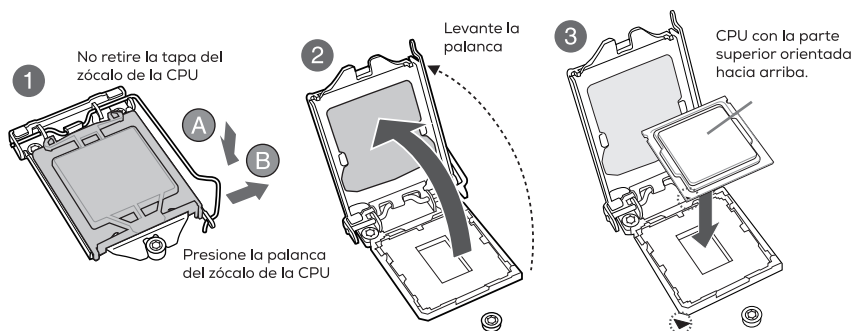

Instalación del cooler de la CPU

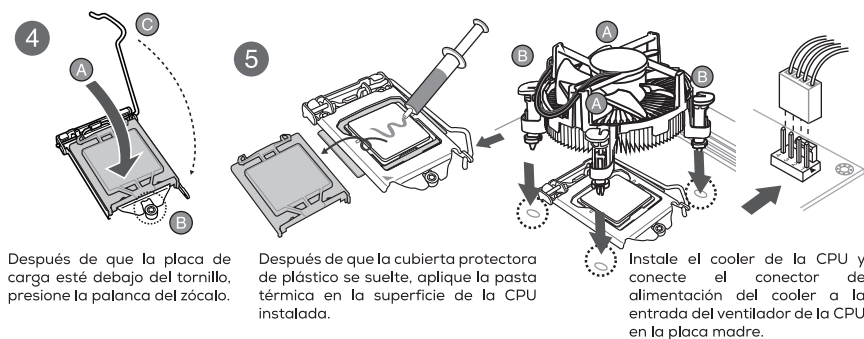

6



Guarde la tapa adecuadamente y siempre colóquela de nuevo cuando la CPU no esté instalada.

Tamaño de la Placa Madre

- Micro ATX

Chipset

- Soporte para Procesadores Intel Core 12/13 th i9/i7/i5/i3/Pentium LGA1700

CPU

- B760

Memoria

- DDR4 Dual Channel: Soporte para frecuencias 2133/2400/2666/3000/3200/3600 MHZ, soporte a XMP
- Máx 64GB (32GB*2)
- 2 slots DDR4 de 288 pines

Puertos Traseros (Rear I/O)

- PS/2: 1 puerto KB + 1 puerto MS
- Puerto de Vídeo: 1 puerto HDMI + 1 puerto VGA + 1 puerto DP
- Puertos USB: 4 puertos USB 2.0; 2 puertos USB 3.1
- Ethernet: Gigabit
- Audio: 1 entrada de micrófono (Mic-in), 1 salida de línea (Line-out), 1 entrada de línea (Line-in)

Conectores Internos

- Conector CFAN: 1 conector de ventilador de 4 pines
- Conectores SFAN: 2 conectores (1 de 4 pines + 1 de 3 pines)
- Puerto ATXPWR: 1 toma de energía estándar de 8 pines; 1 toma de energía estándar de 24 pines
- USB2.0: 1 conectores (Un FUSB puede generar dos puertos USB2.0)
- USB3.0: 1 conectores (Un FUSB puede generar dos puertos USB3.0)
- Puerto COM: 1 conector de 2x5 pines
- Puerto WIFI: 1 soporta los protocolos CNVi y PCIe
- TPM: 1 conector de 2x6 pines (Soporta el módulo TPM MSI)
- Puertos SATA: 4 puertos SATA3.0
- M.2: 1 (ancho de banda PCIe GEN4 X4)
- F_AUDIO: 1 conector de 2x5 pines
- PCIe: 1 slot PCIe X16 4.0; 1 slot PCIe X1 3.0
- F_PANEL: 1 conector de 2x5 pines

**GRACIAS POR ELEGIR A PICHAU GROUP
COMO PARTE DE SU TRAYECTORIA.**



PICHAU

**EXPLORE NUESTROS SITIOS WEB Y ENCUENTRE
EL PRODUCTO IDEAL PARA ELEVAR SU EXPERIENCIA.**